

# Accessories

## Split-core Current Transformer, 1-Phase AC

### Type SCT140/80

CARLO GAVAZZI



- Split-core current transformer
- Cable/bus-bar type current transformer
- 5A (or 1A on request) secondary current
- Screws and nuts for busbar mounting
- Class 0.5 available on request

### Product Description

These split core current transformers can be used for currents from 400A to 1600A. The current transformers are made according to BS3938, EN60044-1 and DIN42600 standards.

### Ordering Key

**SCT14080 4005A C1**

Model \_\_\_\_\_  
 Primary current \_\_\_\_\_  
 Secondary current \_\_\_\_\_  
 Accuracy class \_\_\_\_\_

### Type Selection

Model SCT140/80	Primary Current	Secondary current	Accuracy class
Bus-bar size: 81 x 51 mm	Refer to Range Table	5A 1A (on request)	1 ... 3 (see table) 0.5 (on request)

### Input Specifications

Operating frequency	50 to 60 Hz
Max. system voltage	0.72 kV
Rated insulation level	4kV <sub>RMS</sub> , 50Hz, 1 min
Short-time current rating	60 I <sub>n</sub> 2.5 x I <sub>th</sub>
Extended current rating	120%
Security factor (FS)	5, 10

### Output Specifications

Rated secondary current	5 A 1 A (on request)
-------------------------	-------------------------

### General Specifications

Insulation class	E (MAX 120°C)
Protection	IP00
Working temperature range	-20 to 45°C
Storage temperature	-50 to 80°C
Standards	According to BS3938, EN60044-1 and DIN42600
Connection	The secondary terminals have two connections on each side. Connection with M4 (M5) screws easy to handle and securing low contact resistance.
Housing	ABS, self-extinguishing: UL 94 V-0
Mounting	Panel mounting (bracket supplied with the CT)
Standard accessories	Screws and nuts for busbar mounting
Accessories on request	None
Special features	The terminal cover is fitted for a lead seal. This execution complies with the VGB4 protection of DIN57106 standard.
Cable diameter	Max. 51 mm
Bus-bar size	81 x 51 mm



Range Table

Rated Primary Current	Rated secondary current 5 A (1 A on request)			Primary Current	Class 1 Burden (VA)	Class 3 Burden	Class 0.5 (*) Burden
	Class 1 Burden	Class 3 Burden	Class 0.5 (*) Burden				
400 A	-	5 VA	-	1000 A	5	20 VA	5 VA
500 A	2.5 VA	5 VA	-	1200 A	5/10/15	20 VA	5/10 VA
600 A	3.75 VA	7.5 VA	1.5 VA	1250 A	5/10/15	20 VA	5/10 VA
750 A	5/7.5 VA	10 VA	2.5 VA	1500 A	10/15/20	30 VA	5/10/15 VA
800 A	5/7.5 VA	10 VA	3.75 VA	1600 A	5/10/15/20	30 VA	5/10/15 VA

**Note:** every accuracy class is showing many Burden values: the first value (e.g. 5 out of 5/10/15VA) is available as standard, while the other ones are available on request.

\* On request

Dimensions (mm)

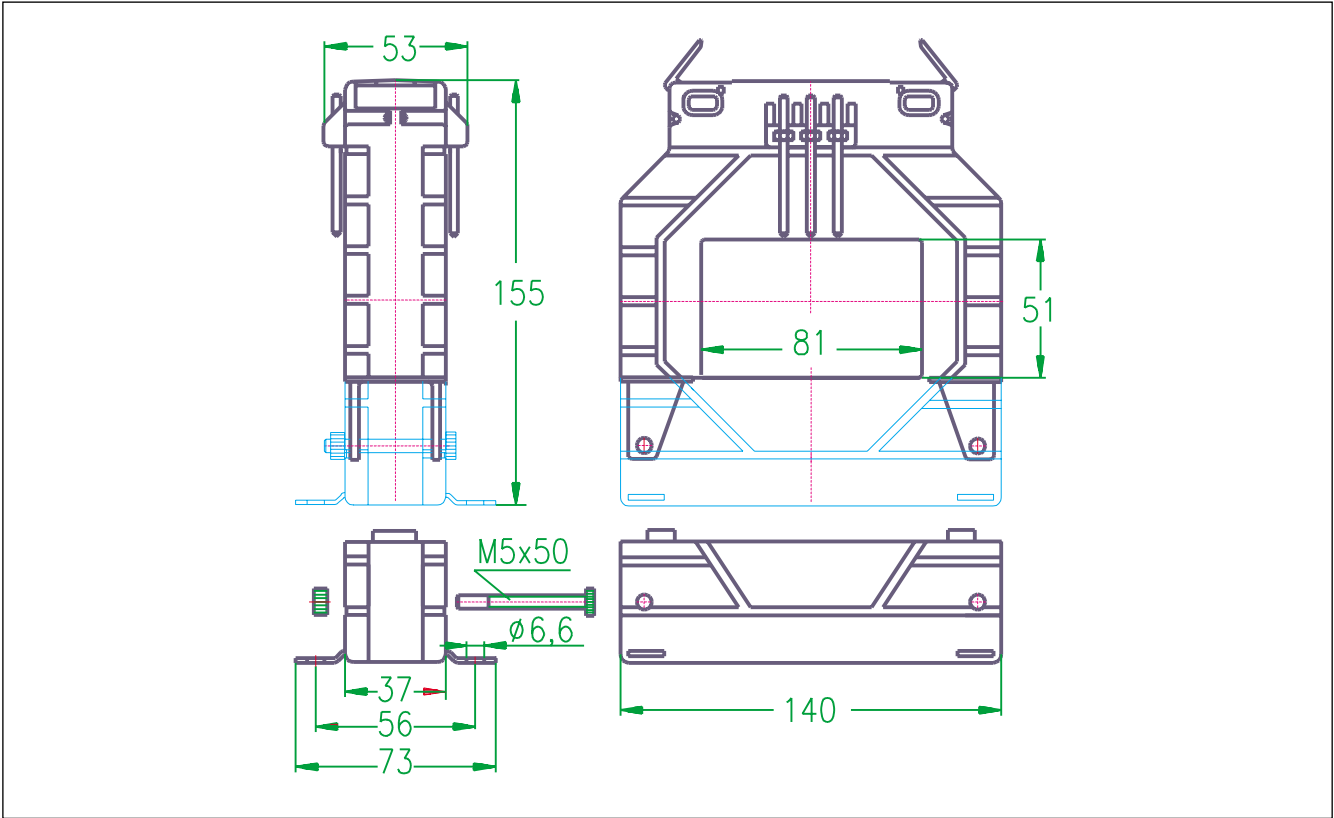

Wiring Diagram

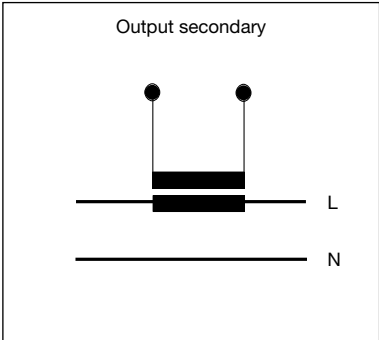

Standard Accessories

Screws and nuts for busbar mounting

